

important

The surface must be free of dust, grease and other impurities to make sure that the adhesive force is not affected.

The surface shouldn't contain silicone. Paints must be fully dried. A test sticker for testing the adhesive strength is included in each order.

Use a squeegee or other equipment instead of your hand to avoid skin injury from the rough sheet.

step 1

Spread the wall tattoo on a flat surface with the transparent side up.

Press the transparent foil with a squeegee or a towel to make sure that the tattoo adheres well.

If the tattoo consists of several parts to be attached at different places it can be cut with scissors.



step 2

Turn the wall tattoo with the transparent sheet on bottom.

Slowly pull off the white backing paper at a flat angle. The entire tattoo has to stick on the transparent sheet.

If small parts don't stick on the transparent foil please press it again and repeat until all parts are on the transparent foil.



step 3

Attach the wall tattoo on a preferred location beginning with a corner. Press the sheet with a squeegee or a towel firmly to the surface.

Large designs should be installed with help of a second person.

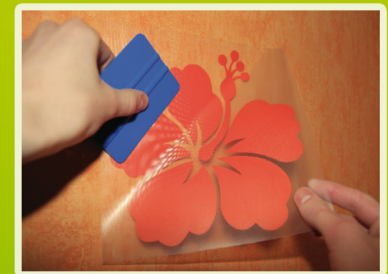

step 4

Detach the transparent sheet slowly at a very flat angle.

If parts of the tattoo remain on the transparent sheet, press it again and repeat until all parts stick on the surface.

Tattoos with small details - as well as certain surfaces - may need more care on attaching.

Finally press down the entire wall tattoo again gently.

